

# Eclipse Systems, Inc.

## Compression Style Sidelite Frame Installation Instructions

ROUGH OPENING SHOULD BE NOMINAL DOOR WIDTH + INSIDE SIDELITE WIDTH + 3" AND  
NOMINAL HEIGHT + 3/4"

**1)** INSTALL DOOR FRAME ACCORDING TO THE ECLIPSE DOOR FRAME INSTALLATION INSTRUCTIONS.

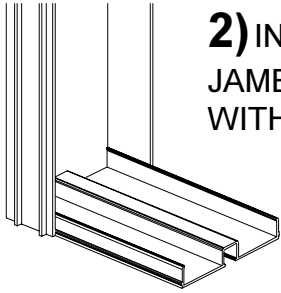

**2)** INVERT AND INSERT GLAZING SNAP-IN AT BASE AT DOOR FRAME STRIKE JAMB. SECURE SNAP-IN TO FLOOR WITH STEEL PINS AND TO STRIKE JAMB WITH 1/2" SELF-TAPPING PAN HEAD SCREWS.

**3)** ATTACH VERTICAL GLAZING SNAP-IN TO FULL LENGTH OF DOOR FRAME STRIKE JAMB. SECURE SNAP-IN TO JAMB USING 1/2" SELF-TAPPING PAN HEAD SCREWS SPACED 12" O.C.

**4)** PLACING GLAZING HEAD COMPONENT ON GROUND, INSTALL CORNER CLIP ON ONE END OF RAIL USING 1/2" SELF TAPPING PAN HEAD SCREWS

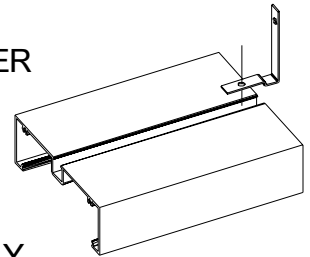

**5)** MAKE SURE "NOTCH" IN CLIP IS SECURED TIGHTLY AGAINST HEAD RAIL COMPONENT. INSTALL GLAZING HEAD RAIL INTO ROUGH OPENING.

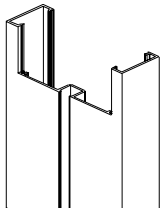
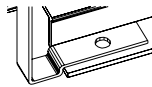

**6)** NOTCH END OF VERTICAL GLAZING RAIL, AS SHOWN, AND INSTALL OVER ROUGH OPENING.

**7)** SECURE VERTICAL GLAZING RAIL SLIDING CORNER CLIP FROM HEAD COMPONENT INTO GLAZING POCKET IN VERTICAL LEG. WITH CORNER AND GLAZING POCKETS ALINED SECURE WITH 1/2" SELF TAPPING PAN HEAD SCREWS THROUGH CLIP INTO EACH VERTICAL LEG.

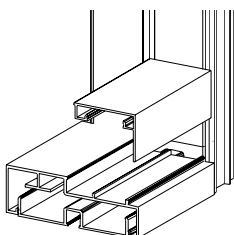
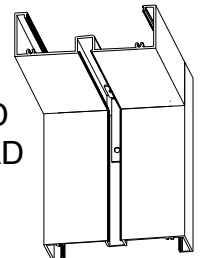

**8)** SNAP GLAZING SILL OVER INVERTED RAIL AT THE BASE OF THE SIDELITE